

versatile™ 4C Surface Mount Collar, SM15S

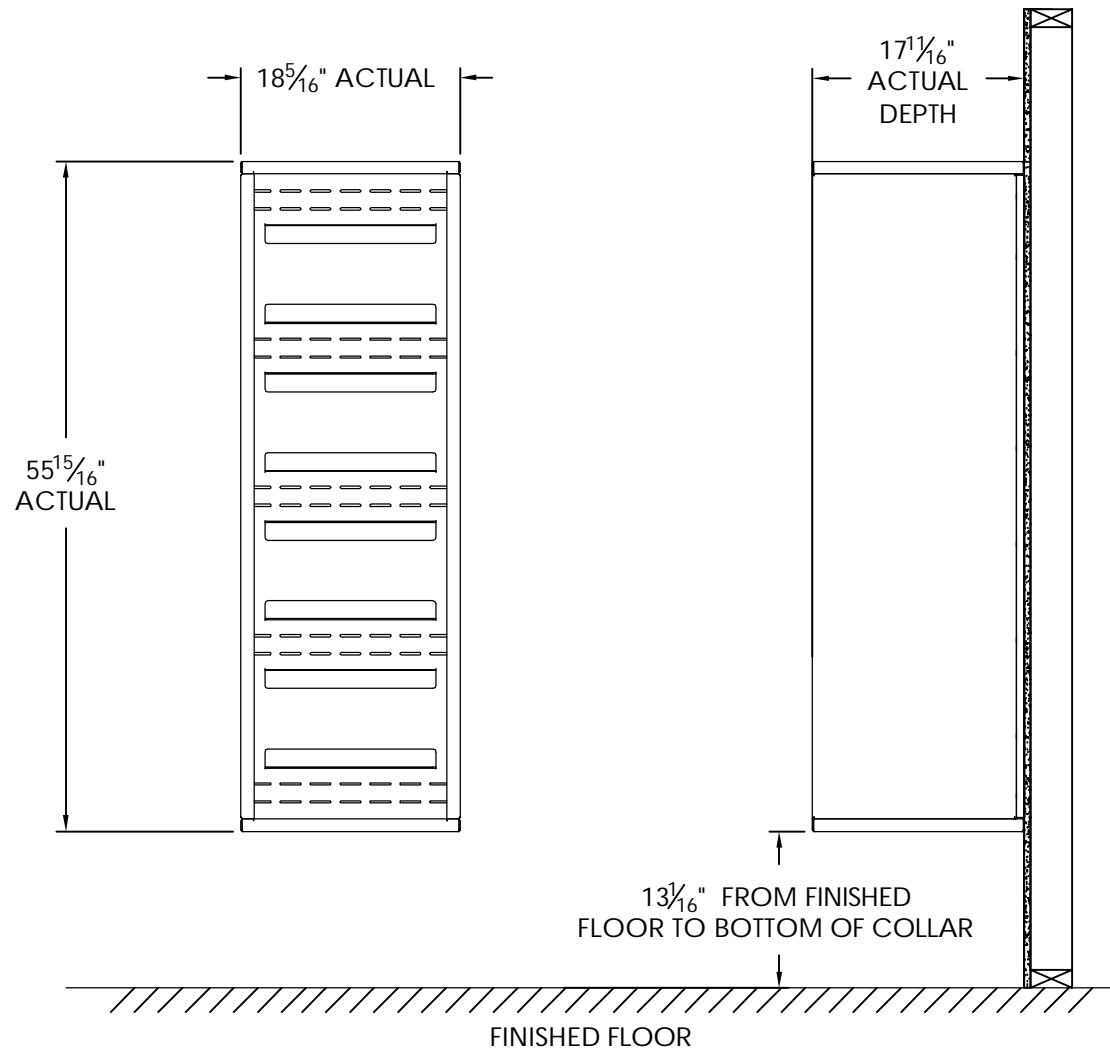

Notes:

1. Designed to mount Florence Versatile™ 4C mailbox single column 15-High Suite modules (sold separately).
2. For use with front loading modules only.

PRODUCT SERIES: VERSATILE™ 4C SURFACE MOUNT COLLAR

AF FLORENCE
manufacturing company

5935 Corporate Drive • Manhattan, KS 66503
www.florencemailboxes.com • (800) 275-1747

A GIBRALTAR INDUSTRIES COMPANY

| | | | |
|----------------|---------|---------------|-----------|
| MODEL | SM15S | REV | B |
| SCALE | NONE | LAST REV DATE | 7/02/2014 |
| DRAWING NUMBER | SM15SCS | DRAWN BY | TNS |

versatile™ 4C Trash/Recycling Bin, 4C15S-BIN

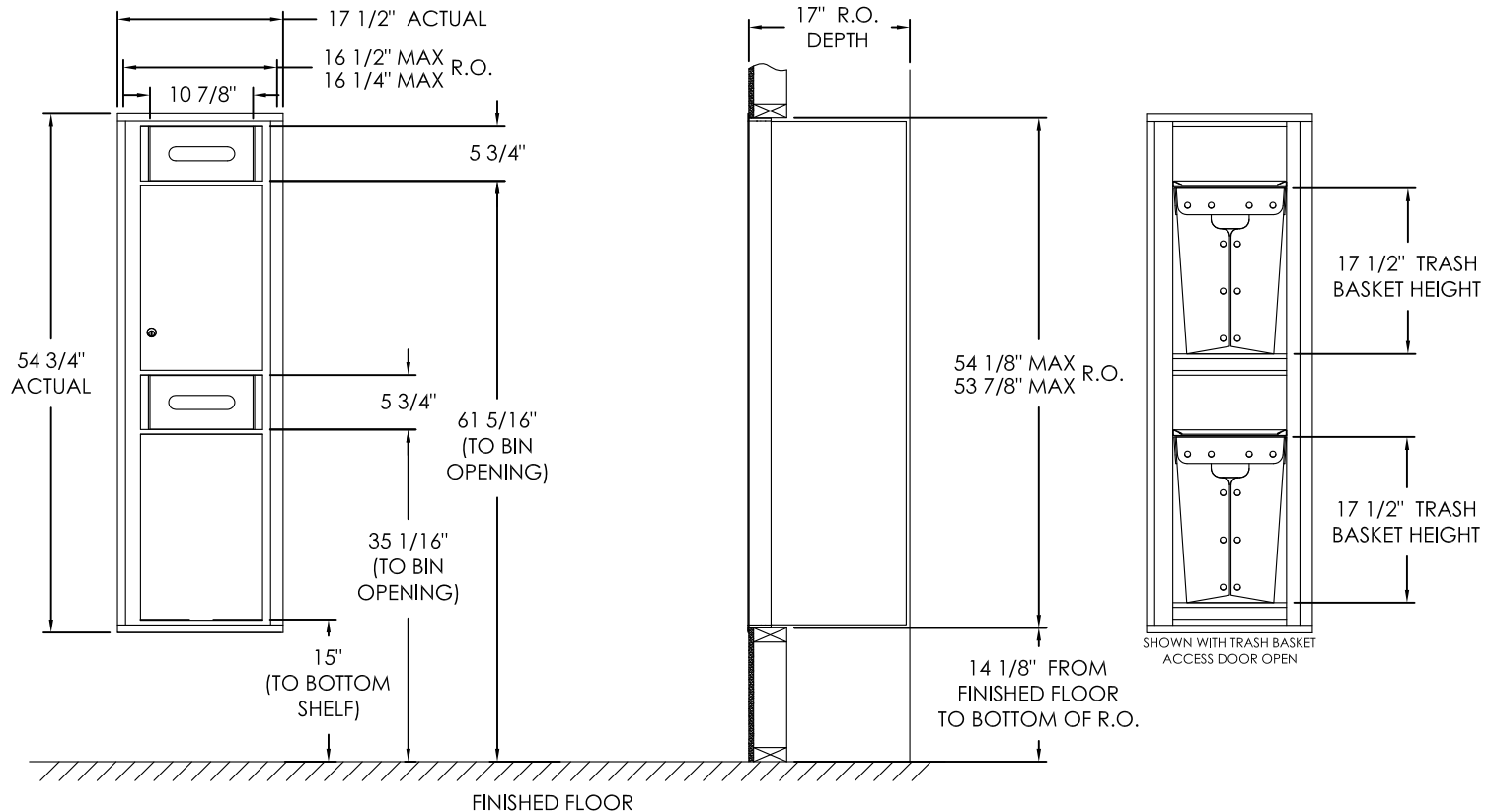

Notes:

1. 4C Trash/Recycling Bins are for private application only / not USPS Approved.
2. Module may be recessed, surface, or pedestal mounted and coordinates with Florence 4C mailbox modules, see installation manual for details.
3. Includes (2) trash/recycling compartments, (2) 10-gallon trash baskets made of recycled plastic and customized to compartments (Note: trash bag furnished by others).

PRODUCT SERIES: VERSATILE™ 4C TRASH/RECYCLING BIN

FLORENCE
CORPORATION

5935 Corporate Drive • Manhattan, KS 66503
 800.275.1747 • www.florencemailboxes.com

| | | | |
|----------------|-------------|---------------|----------|
| MODEL | 4C15S-BIN | REV | B |
| SCALE | NONE | LAST REV DATE | 07/08/19 |
| DRAWING NUMBER | 4C15S-BINCS | DRAWN BY | RAK |